

| REV | REVISION | NAME | DATE |
|-----|-----------------|----------|---------------|
| A/0 | Update Drawings | KAIGE.XU | Sep. 20. 2019 |
| A/1 | Update Code | KAIGE.XU | Jul. 29. 2022 |

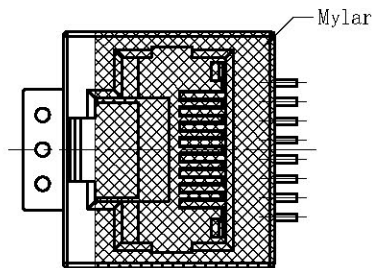
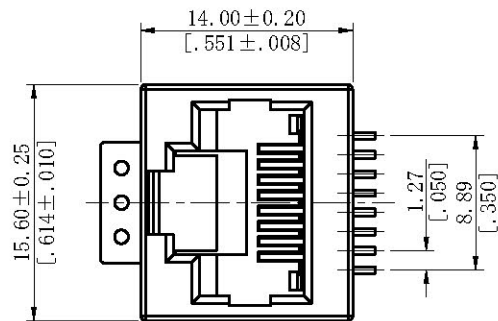

Electrical:

Voltage Rating:125 VAC RMS.
 Current Rating:1.5AMP.
 Contact Resistance:30mΩ Max.
 Insulation Resistance:500 MegaHMS MIN@500 VDC.
 Dielectric Strength:1000VAC RMS 50Hz. 1Min.

Mechanical:

Housing Material:Glass Filled Polyester UL94V-0.
 Standard:LCP, Black Color.
 Contact Material:Phosphor Bronz(T=0.30mm).
 Contact Plating:Gold Or Tin Plating Over Nickel.
 Metal Gasket:Copper Alloy(T=0.35mm),Plated Tin.
 Operating Life:750 Cycles Min.
 Mating Force:<2.2Kg. f.
 Retention Strength:5.1Kg. f Between Jack and Plug.

Environmental:

Storage Temp Range:-40℃~+85℃
 Operating Temp Range:-40℃~+85℃
 Packaging:200PCS/Reel.

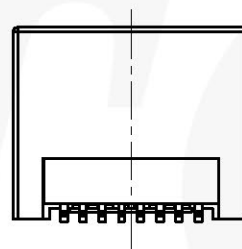
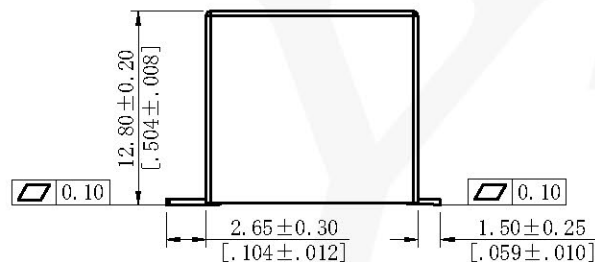

Ordering Code:
 6501-881 XX D X 00 M 01

| | |
|--|--|
| Contact Plating S0=GoldFlash/Tin S1=3u" Gold/Tin S2=5u" Gold/Tin S3=10U"Gold/Tin S4=15U"Gold/Tin S5=30U"Gold/Tin | Color Insulator B=Black W=White U=Blue R=Red Y=Yellow G=Grey |
|--|--|

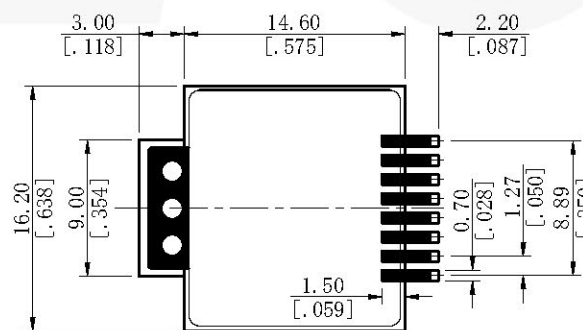
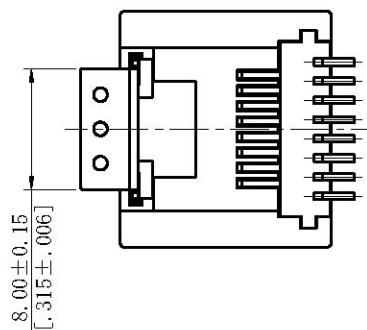

Recommended P. C. B Layout (Top Side)
 (PCB BOARD TOLERANCE ± 0.05)

2022.07.29
 ISSUED

| ITEM | Part No. |
|-----------|-------------------|
| Standard | 6501-881S1DB00M01 |
| Alternate | |

THIS DRAWING IS A CONTROLLED DOCUMENT

| TOLERANCES UNLESS OTHERWISE SPECIFIED | UNITS mm/inch | SCALE FIT | SIZE A4 |
|---------------------------------------|---------------|-----------|---------|
| 0 PLC ± — | | | |
| 1 PLC ± 0.30/.012 | | | |
| 2 PLC ± 0.25/.010 | | | |
| 3 PLC ± 0.20/.008 | | | |
| 4 PLC ± 0.10/.004 | | | |
| ANGLES ± 3° | | | |

YTCO TECHNOLOGY
 HTTP://WWW.YTCO.CO E-MAIL:SALES@YTCO.CO

| TITLE | PART NO. | DRAWING NO. | FILE PATH | SHEET | REV |
|---|-------------------|-------------|--------------------|--------|-----|
| MODULAR JACK 8 POSITION TOP ENTRY SMT TYPE | 6501-881XXDX00M01 | 6501 | A/D/YTCOTZ/RJ/6501 | 1 OF 1 | A |

| REV | REVISION | NAME | DATE |
|-----|-----------------|----------|---------------|
| A/0 | Update Drawings | KAIGE.XU | Sep. 20. 2019 |
| A/1 | Update Code | KAIGE.XU | Jul. 29. 2022 |

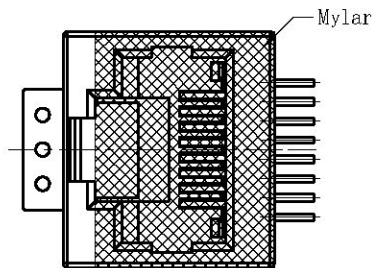
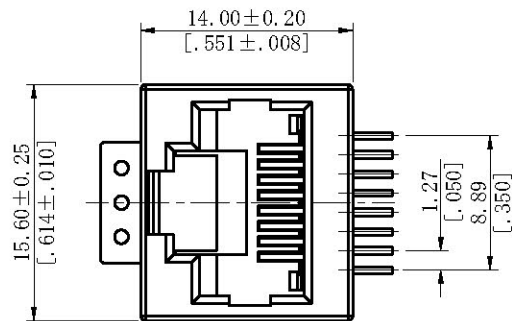

Electrical:
 Voltage Rating: 125 VAC RMS.
 Current Rating: 1.5AMP.
 Contact Resistance: 30mΩ Max.
 Insulation Resistance: 500 MegaHMS MIN@500 VDC.
 Dielectric Strength: 1000VAC RMS 50Hz. 1Min.
Mechanical:
 Housing Material: Glass Filled Polyester UL94V-0.
 Standard: LCP, Black Color.
 Contact Material: Phosphor Bronz (T=0.30mm).
 Contact Plating: Gold Or Tin Plating Over Nickel.
 Metal Gasket: Copper Alloy (T=0.35mm), Plated Tin.
 Operating Life: 750 Cycles Min.
 Mating Force: < 2.2Kg. f.
 Retention Strength: 5.1Kg. f Between Jack and Plug.
Environmental:
 Storage Temp Range: -40°C ~ +85°C
 Operating Temp Range: -40°C ~ +85°C
 Packaging: 200PCS/Reel.

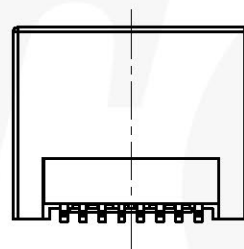
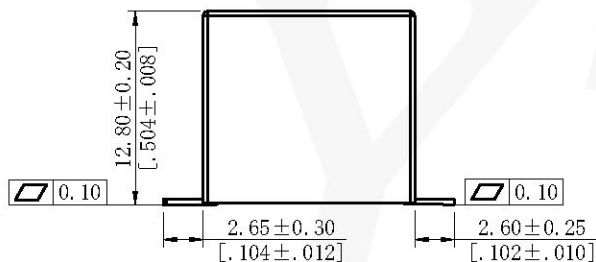

Ordering Code:
 6501-881 XX D X 00 M 02

| | |
|---|--|
| Contact Plating S0=GoldFlash/Tin S1=3u" Gold/Tin S2=5u" Gold/Tin S3=10u" Gold/Tin S4=15u" Gold/Tin S5=30u" Gold/Tin | Color Insulator B=Black W=White U=Blue R=Red Y=Yellow G=Grey |
|---|--|

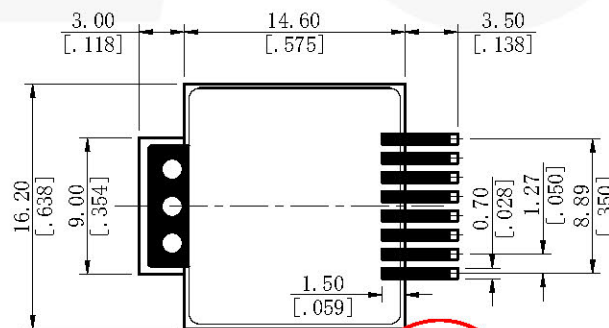
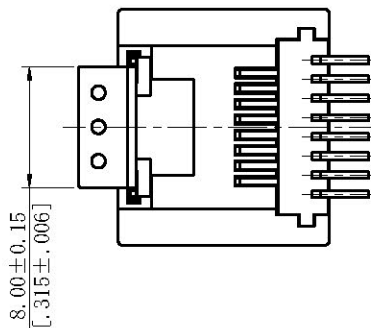

Recommended P. C. B Layout (Top Side)
 (PCB BOARD TOLERANCE ± 0.20)

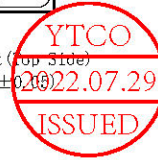

THIS DRAWING IS A CONTROLLED DOCUMENT

TOLERANCES UNLESS OTHERWISE SPECIFIED

| | | |
|--------|---|-----------|
| 0 PLC | ± | — |
| 1 PLC | ± | 0.30/.012 |
| 2 PLC | ± | 0.25/.010 |
| 3 PLC | ± | 0.20/.008 |
| 4 PLC | ± | 0.10/.004 |
| ANGLES | ± | 3° |

| UNITS | SCALE | SIZE |
|-------------|--------------|--|
| mm/inch | FIT | A4 |
| DRAWN BY | DATE | TITLE |
| Xu | 7/29/2022 | MODULAR JACK 8 POSITION TOP ENTRY SMT TYPE |
| ENGINEER | DATE | PART NO. |
| Zhang | 7/29/2022 | 6501-881XXDX00M02 |
| CHECKED BY | DATE | DRAWING NO. |
| Mike | 7/29/2022 | 6501 |
| APPROVED BY | DATE | FILE PATH |
| Andy | 7/29/2022 | A/D/YTCOTZ/RJ/6501 |
| PROJ. | DRAWING CODE | SHEET |
| 594309442 | | 1 OF 1 |

| ITEM | Part No. |
|-----------|-------------------|
| Standard | 6501-881S1DB00M02 |
| Alternate | |

YTCO TECHNOLOGY
 HTTP://WWW.YTCO.CO E-MAIL:SALES@YTCO.CO

MODULAR JACK 8 POSITION
 TOP ENTRY SMT TYPE

6501-881XXDX00M02

6501

A/D/YTCOTZ/RJ/6501

SHEET 1 OF 1 REV A